

# LAWN SPRINKLER PUMPS

For lawn and turf sprinkling, irrigation and water transfer

## SPJ Self-Priming

- High capacity, high volume
- Cast iron pump body and mounting ring for long life
- Flint & Walling's Service Plus NEMA J, capacitor start, double ball bearing motors for continuous operation
- Easy access drain plug
- Rapid self-priming characteristics under maximum suction conditions



---

Single or Three Phase

---

SPJ 3/4 - 3 HP

---

**FW**®  
FLINT & WALLING  
Trust runs deep.®

# SPJ SELF-PRIMING 3/4 - 3 HP SINGLE OR THREE PHASE

PERFORMANCE CHART

Model Number		HP	Suction Lift Ft.	Discharge Pressure PSI								Shut-Off Pressure PSI	Suction Pipe Tap	Disch. Pipe Tap
				10	15	20	25	30	35	40	45			
1 Phase	3 Phase			Capacity - U.S. Gallons per Minute										
SPJ07P1	SPJ07P3	3/4	5	56	48	42	37	29	21			41	2"	1-1/2"
			15	47	42	37	29	22	12	37				
			25	43	37	31	22	10		33				
SPJ10P1	SPJ10P3	1	5	58	53	48	43	38	32	23	11	48	2"	1-1/2"
			15	53	48	45	37	31	24	43				
			25	48	44	38	33	25	14	39				
SPJ15P1 SPJ15B1	SPJ15B3	1-1/2	5	78	77	74	70	62	53	43	30	47	2"	1-1/2"
			15	70	68	66	62	53	43	41				
			25	47	46	45	44	42	34	36				
SPJ20B1	SPJ20B3	2	5	86	84	81	77	71	62	52	40	50	2"	1-1/2"
			15	76	74	72	69	64	55	43	45			
			25	52	51	50	47	45	42	30	40			
SPJ30B1	SPJ30B3	3	5	88	86	85	84	80	73	64	53	54	2"	1-1/2"
			15	77	76	75	74	72	65	55	43	50		
			25	54	53	52	51	50	49	45	10	45		

Motor voltage: Single Phase 3/4 - 2 HP - 115/230V; 3 HP - 230V, 60Hz  
 Three Phase 3/4 - 2 HP - 208 - 230/460V, 50/60Hz; 3 HP - 208 - 230/460V; 60Hz  
 Maximum Case Pressure: 100 PSI

PERFORMANCE CURVES / SPECIFICATIONS

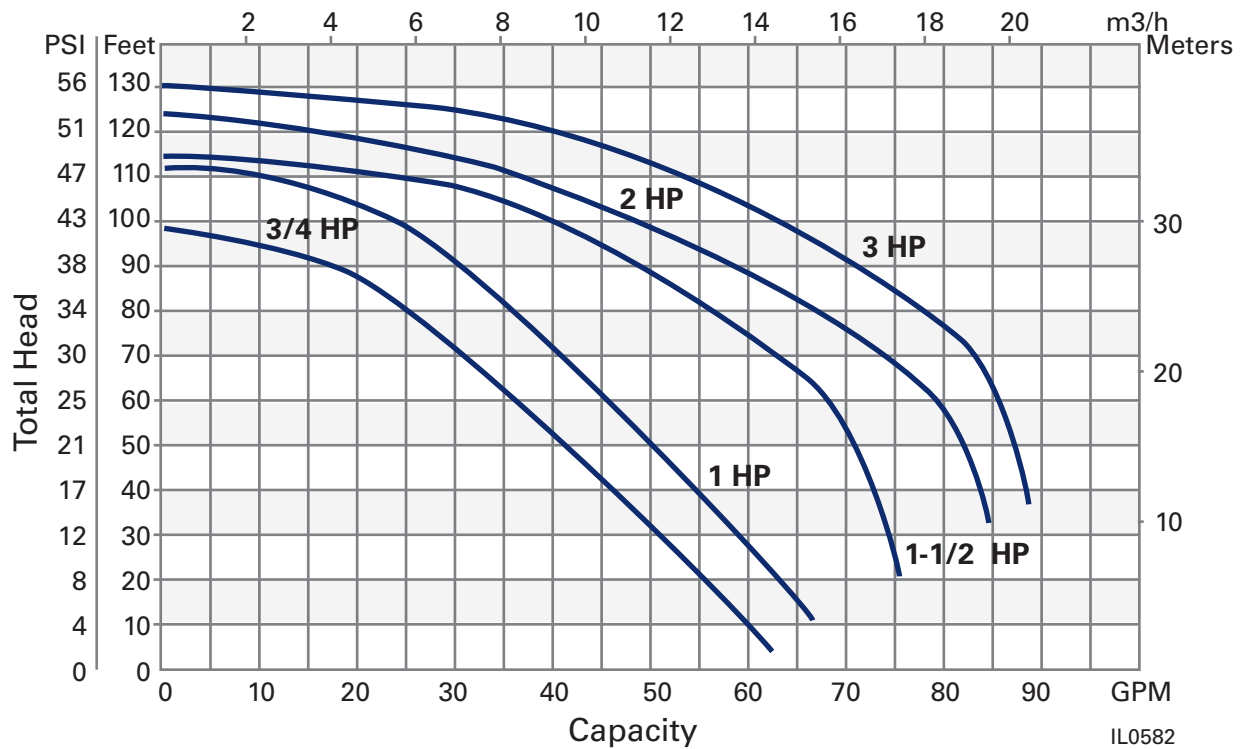



# SPJ SELF-PRIMING 3/4 - 3 HP SINGLE OR THREE PHASE

## SPECIFICATIONS

HP	Type	Volts	Hz	RPM	Motor Voltage (Factory) Connected	Service Factor Motor Amps				Max Liquid Temp	Max Suction Lift
						Single Phase		Three Phase			
						115V	230V	230V	460V		
3/4	Single Ph	115/230	60	3450	115V	14.0	7.0	-	-	180°F	25 Ft.
1					230V	18.0	9.0				
1-1/2						21.0	10.5				
2						25.0	12.5				
3		230				-	13.5				
3/4	Three Ph	208-230/460	60/50	3450/2850	230V	-	-	3.5	1.75	180°F	25 Ft.
1								4.5	2.25		
1-1/2								5.7	2.85		
2								7.4	3.70		
3								9.8	4.90		

Suction lift varies, depending upon elevation (altitude) and water temperatures.

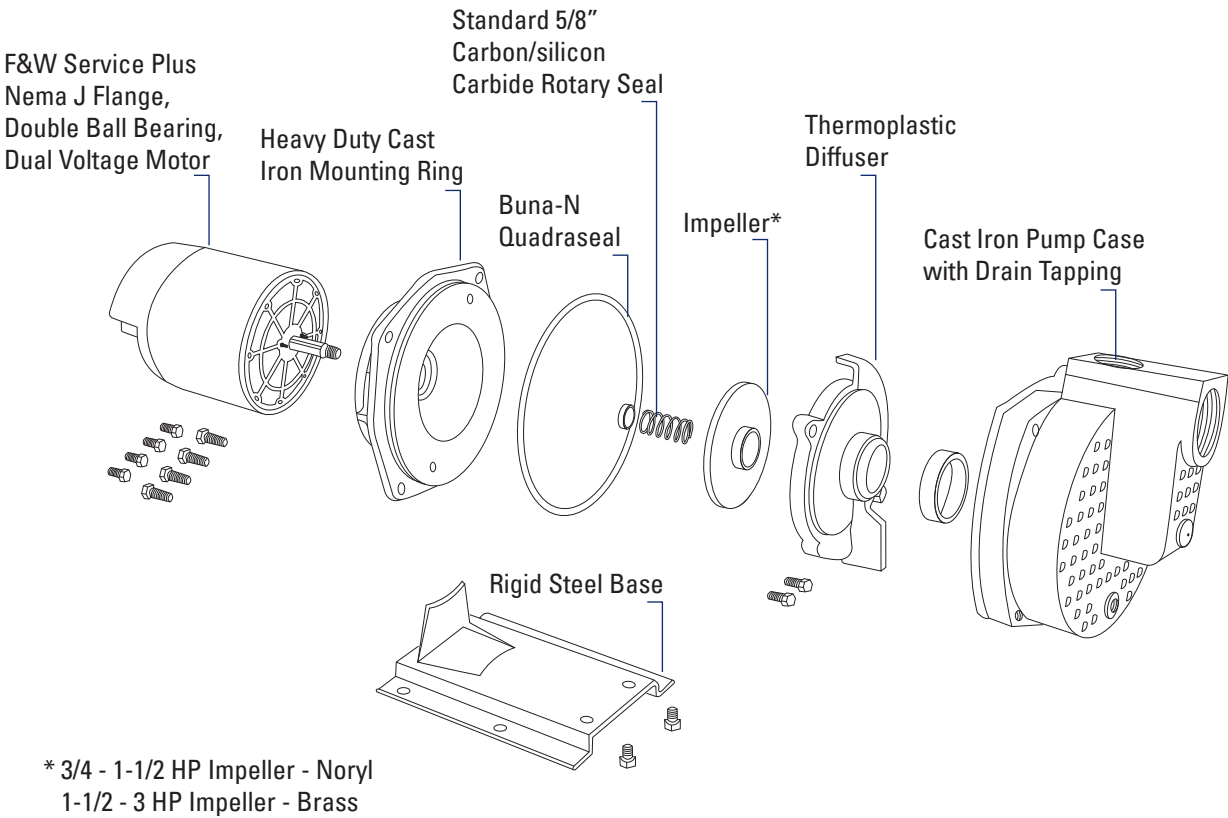

## Dedicated to Service and Education

### SERVICE

- Selecting the Right Application
- Pump Sizing & Specifications
- Installation Tips
- Pump Troubleshooting

Contact F&W Product Support

**800-742-5044**

[tech@FlintandWalling.com](mailto:tech@FlintandWalling.com)

7:30am - 5:00pm Mon - Fri

Over 90% of phone calls to Product Support are answered by a live person within three rings!

### TRAINING

- Factory Tours & Training
- CEU Accreditation
- Local Branch Training
- Web Conferences

Contact Dan Painter

F&W Product Training & Development Manager

**260-615-9795**

[dpainter@FlintandWalling.com](mailto:dpainter@FlintandWalling.com)

Dan has over 37 years of experience in the water systems industry

*Flint & Walling, a family-owned American manufacturer of premium pumps, motors and controls. Built on proven, comprehensive testing and generations of deep personal relationships with loyal customers and employees. A legacy of high-quality, American-made products where trust flows through everything we do.*